

MILFORD FIRE DEPARTMENT



Introduction to the Mobile Computer Project

Dan Worroll Jr, EOC Coordinator

Gary Guilmette

MOBILE COMPUTER PROJECT COMPONENTS

1. HARDWARE
2. GIS
3. GPS
4. PREPLAN

HARDWARE

- **Military grade mobile PC with GIS and Preplan software**
- **Touch Screen interface**
- **Programmable “HOT” keys**
- **No Mouse or Keyboard**
- **Cellular communication through wireless modem**
- **Internal GPS receiver**

DCI-CORPORATION

“Predator III”

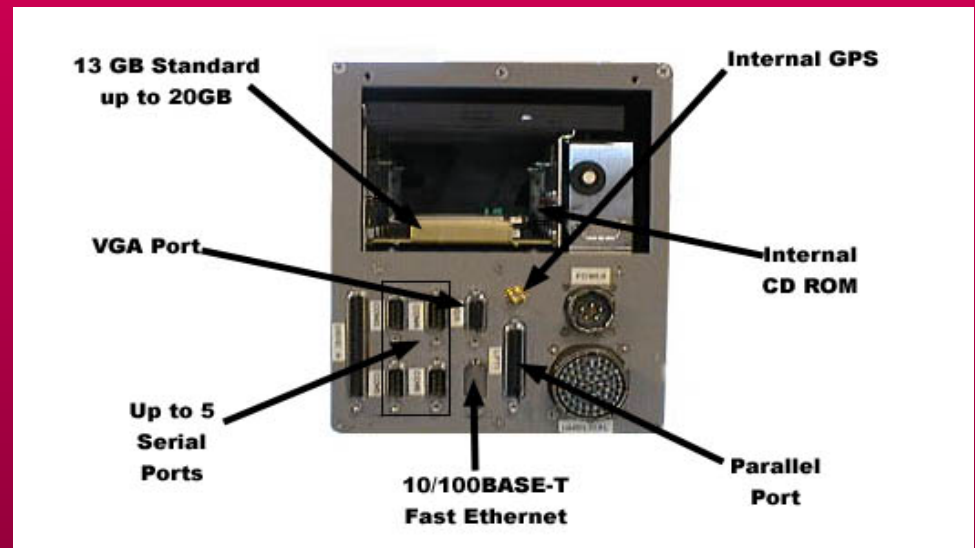
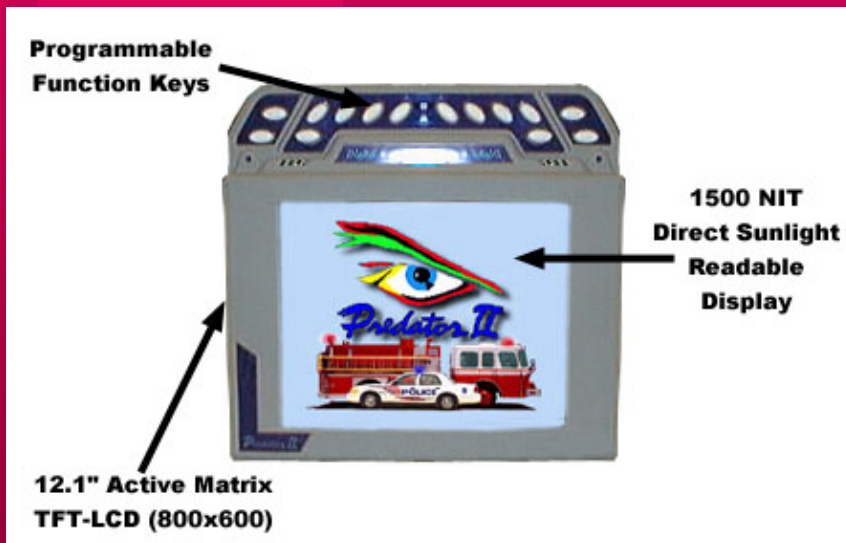

STATION MAPS

Full Size Maps at all Stations



BOOK MAPS

Close Up of Individual Footprints



ARE THERE PROBLEMS WITH MAPS?

Problems Using Paper Maps

- **Objects Can be outside the bounds of the Map**
- **Information Can be Missing (Omitted)**
- **Excess Information can be shown (Committed)**
- **What You See is What You Get (Static)**
- **The information is outdated once the map is printed**

PLANT EQUIPMENT

Map Mobile



GPS

GPS – Global Positioning System

- Constellation of 24+ satellites providing accurate location information in-conjunction with ground instruments both end-user and Department of Defense
- Based on time measurements between satellites and ground instruments
- Requires line of sight between satellites and ground instruments thus will not function indoors
- GPS Location displayed within Map Mobile GIS software

PREPLAN INFORMATION

- Floor plans and photos
- Structural Information
- Access Information
- Water Supply Information
- HAZMAT and DOT guidebook
- Strategy Information
- Contact Information

CAD ZONE

First Look Pro

First Look Pro 2.0 - Milford Fire Department

File Help

View Mode First Prev Next Last Print

THE FIRE ZONE
First Look Pro

Occupant # 52 of 22355

Occupant CALF PEN MEADOW SCHOOL PrePlan ID 0000000150

Address 1 395 WELCHS POINT RD

Address 2

City Milford State CT Zip 06460

Map Page 105 Last Inspection 12/8/1999

Notes Occupancy Type = Elementary School
Cross Streets: Buckingham Ave. & Indian River Rd.

Diagram # 2 of 4

Name 395 WELCHS POINT RD-

Path \Viewer\Diagrams\ADDRESS ED\WELCHS POINT RD\

Notes

Structure

Access

H2O

Protection

HazMat

Strategy

Contacts

Structural Information

Construction Class Roof Construction

Non-Combustible Metal Deck with Steel

Overall Dimensions # of Roof Covering

Length	Width	Height	Stories	
0	0	0	1	

Fire Flow Iowa State Univ. Method

25 %	50 %	75 %	100 %
0	0	0	0

Notes Truss Const. = N/A
Parapet Walls = 0'

W **All** **R**

FLOOR PLAN DRAWINGS

Fire Zone

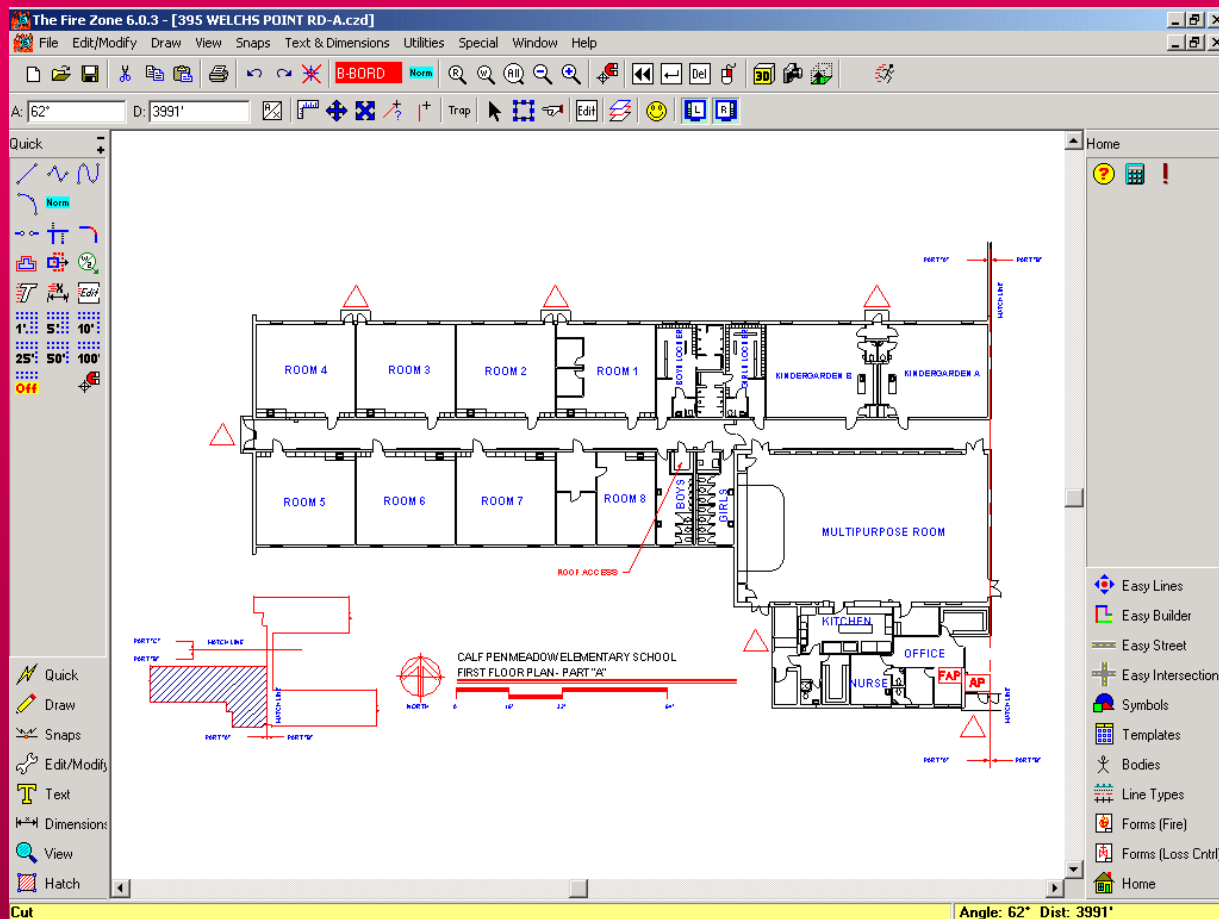

HOW WILL IT WORK?

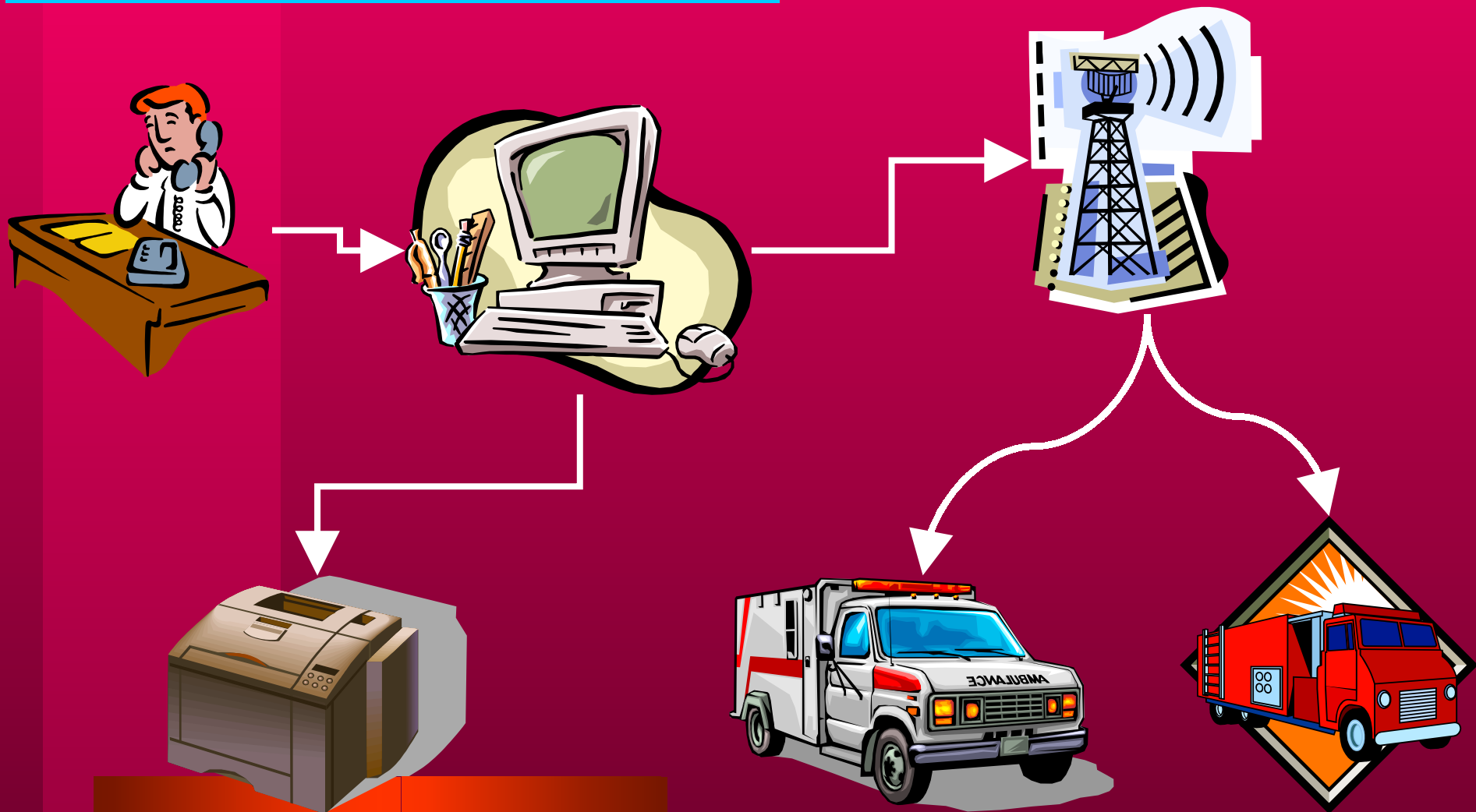

HOW WILL IT WORK?

- 1. 911 Call into dispatch**
- 2. Address 'string' sent from dispatch to appropriate unit over wireless connection via TCP/IP**
- 3. Address 'String' read by First Look Pro and Map Mobile**
- 4. Address matched in First Look Pro and Map Mobile**